



Haringey Council

Licensing Sub Committee B

TUESDAY, 22ND JANUARY, 2013 at 19:00 HRS - CIVIC CENTRE, HIGH ROAD, WOOD GREEN, N22 8LE.

MEMBERS: Councillors Beacham, Brabazon and Demirci (Chair)

AGENDA

1. APOLOGIES FOR ABSENCE

2. URGENT BUSINESS

The Chair will consider the admission of any late items of urgent business. (Late items will be considered under the agenda item where they appear. New items will be considered at item 7 below).

3. DECLARATIONS OF INTEREST

A member with a disclosable pecuniary interest or a prejudicial interest in a matter who attends a meeting of the authority at which the matter is considered:

(i) must disclose the interest at the start of the meeting or when the interest becomes apparent, and

(ii) may not participate in any discussion or vote on the matter and must withdraw from the meeting room.

A member who discloses at a meeting a disclosable pecuniary interest which is not registered in the Register of Members' Interests or the subject of a pending notification must notify the Monitoring Officer of the interest within 28 days of the disclosure.

Disclosable pecuniary interests, personal interests and prejudicial interests are defined at Paragraphs 5-7 and Appendix A of the Members' Code of Conduct

4. MINUTES (PAGES 1 - 6)

To approve the minutes of the previous meeting of the Licensing Sub Committee B held on 29 November 2012.

5. SUMMARY OF PROCEDURE (PAGES 7 - 8)

The Chair will explain the procedure that the Committee will follow for the hearing considered under the Licensing Act 2003 or the Gambling Act 2005. A copy of the procedure is attached.

6. BAR ESTEBAN, GROUND FLOOR, 29 PARK ROAD, LONDON N8 8TE (CROUCH END WARD) (PAGES 9 - 52)

To consider an application to allow the supply of alcohol, provision of live music, recorded music and late night refreshment.

7. ITEMS OF URGENT BUSINESS

To consider any new items of urgent business admitted under item 2 above.

David McNulty
Head of Local Democracy &
Member Services
Level 5, River Park House
225 High Road
Wood Green
London N22 8HQ

Helen Chapman
Principal Committee Coordinator
Level 5, River Park House
225 High Road
Wood Green
London N22 8HQ

Tel: 020 84892615

Email: Helen.Chapman@haringey.gov.uk

Monday, 14 January 2013

**MINUTES OF THE LICENSING SUB COMMITTEE B
THURSDAY, 29 NOVEMBER 2012**

Councillors Beacham, Demirci (Chair) and Mallett

Apologies Councillor Brabazon

MINUTE	SUBJECT/DECISION
PRCE50.	<p>APOLOGIES FOR ABSENCE</p> <p>Apologies for absence were received from Cllr Brabazon, for whom Cllr Mallett was substituting.</p>
PRCE51.	<p>URGENT BUSINESS</p> <p>There were no new items of urgent business.</p>
PRCE52.	<p>DECLARATIONS OF INTEREST</p> <p>Cllr Demirci advised that he had attended an event for election candidates at the Turkish Cypriot Community Association in 2006. It was confirmed that this would not preclude him from participating in the hearing relating to this premises.</p>
PRCE53.	<p>MINUTES</p> <p>RESOLVED</p> <p>That the minutes of the meeting held on 18 June 2012 be approved and signed by the Chair.</p>
PRCE54.	<p>SUMMARY OF PROCEDURE</p> <p>NOTED</p>
PRCE55.	<p>TURKISH CYPRIOT COMMUNITY ASSOCIATION, 628-630 GREEN LANES, LONDON N8 0SD (HARRINGAY WARD)</p> <p>The Licensing Officer, Daliah Barrett, presented the report on an application by the Enforcement Response Team for a review of the premises licence at the TCCA on the basis of breaches of licence conditions. Ms Barrett set out the options available to the Committee, but advised that in this instance it would not be appropriate to remove the DPS, as the DPS named on the licence was no longer in position. It was clarified that, until such time as the DPS was replaced, the premises was not licensed for the sale of alcohol.</p> <p>Derek Pearce, Enforcement Response Team, addressed the Committee regarding the application, and made the following points:</p> <ul style="list-style-type: none"> The premises had been operating outside the conditions of its premises licence, and appeared to have made little effort to address the issues raised, in particular those relating to noise nuisance affecting neighbouring

**MINUTES OF THE LICENSING SUB COMMITTEE B
THURSDAY, 29 NOVEMBER 2012**

properties.

- Despite the condition on the licence that the licence did not come into force until such time as the premises received confirmation in writing from the licensing authority that it was satisfied that the conditions on the licence had been met, there was no evidence that any such confirmation had been sought or received.
- No evidence had been provided that the conditions with regard to sound insulation, mechanical ventilation or sound limiter had been met.
- Residents reported that there were issues with the door to the rear of the premises being opened, causing a noise nuisance, although the nature of such incidents meant that they had often been resolved by the time an enforcement response officer arrived.
- It was reported that it was the licence holder's responsibility to meet all of the conditions on the licence, and seek confirmation from the licensing authority that they were satisfied that this had been done; the Council did send reminders to licence holders where records indicated that this had not been done.
- In response to concern from the licence holders that it was being suggested that they had been operating completely without a licence, Tony Michael, Legal Officer, advised that the focus of this hearing should be whether they had been operating in accordance with the conditions on the licence, as a decision had been made to grant a licence. It was noted that in law it was as serious an offence to breach conditions on a licence as it was to operate without a licence.
- It was reported that the complaints received had been from a number of residents, not just one or two. The Committee was advised that, where officers had attended and not observed a breach, the Committee was being asked to consider hearsay evidence, and this should be given due weight.

Pauline Syddell, a local resident, addressed the Committee in support of the review application, on behalf of residents of numbers 2, 4 and 6 Harringay Gardens, which backed directly onto the rear garden of the premises.

- Residents had called the noise team several times; although the music was not always loud, the condition on the licence was that it should not be audible at all from residential properties.
- Noise from the premises could prevent residents from sleeping, especially in summer.
- Local residents did not oppose the premises having a licence, as long as noise was controlled and the conditions on the licence were adhered to.
- Things had got better in recent weeks, and issues had been less frequent than in the past.
- Residents would like a phone number they could call directly at the premises, rather than complaining to the noise team.
- In response to a question from the Committee regarding times when the noise team had arrived and no nuisance had been detected, Ms Syddell advised that sometimes the noise was only audible when the door was opened and this had stopped by the time the noise team arrived. Also, noise officers sometimes advised that it was only a nuisance if the noise was audible above the level of a TV and that no action could be taken otherwise, but the licence conditions were that it should not be audible at

**MINUTES OF THE LICENSING SUB COMMITTEE B
THURSDAY, 29 NOVEMBER 2012**

all.

- Ms Syddell reported that she had contacted the premises directly in the past, but somebody on the other end of the phone had been very rude to her, and she had not tried again. It was noted that it was important for any contact telephone number at the premises to be answered by a responsible person.

Mr Ibrahim and Ms Hadji-Filippou addressed the Committee on behalf of the premises licence holders.

- The premises did not hold many parties or events; most activities at the premises took place during the daytime.
- The previous kitchen manager had been a musician and had held some events, but had not always controlled the noise from the events effectively. It was reported that the kitchen was now run by new people.
- The licence holders apologised to residents on behalf of the TCCA for any disturbance that had been caused in the past. They were limiting the number of activities held at the centre in order to avoid complaints, and wanted to have as good a relationship as possible with local residents.
- The applicants advised that Mr Ibrahim was the new Chair of the Association, and that he had not been aware of the issues previously; when he found out about the noise problems he had taken steps to change the management of the kitchen .
- Mr Ibrahim stated that he was complying with the licence conditions in respect of putting up signage, alarming the back door so that it could not be used during events except in case of emergency, locking the windows and that he would also provide contact telephone numbers for local residents to use in the event of any disturbance being caused.
- With regard to the condition requiring adequate mechanical ventilation, Mr Ibrahim advised that the centre would hire air conditioning as required for events, due to the cost of permanent installation. With regards to sound insulation, the Association was in the process of obtaining quotes, but indications were that the cost of insulating the building in accordance with the existing condition of the licence would be prohibitive. It was hoped that the problems could be addressed by keeping the doors and windows closed during events as proposed, and that sound insulation would not be necessary.
- In response to a question from the Committee, Mr Ibrahim confirmed that there was adequate space at the front of the premises for smokers to use.
- In response to further questions regarding the measures already out in place to comply with the licence, Mr Ibrahim confirmed that speakers were already mounted so as not to cause vibrations and that a sound limiter was already installed – this had been repaired as it had not been working, and would be tested and maintained on an ongoing basis.
- The applicants advised that they wanted to be made aware of any issues or concerns that neighbours had, so that they could take steps to address them.
- In response to a question from the Committee, it was confirmed that weddings were not held at the premises, due to its small capacity.

In discussion with Mr Pearce, the applicants were advised that they could calibrate the sound limiter by monitoring whether noise from the premises was

**MINUTES OF THE LICENSING SUB COMMITTEE B
THURSDAY, 29 NOVEMBER 2012**

audible at the boundary to neighbouring properties, and that it should not be necessary to gain access to those properties in order to do this. Mr Pearce advised that, were sound insulation not practical for financial reasons, this would affect the level of music that could be played so that it was inaudible from neighbouring residences. The Committee was advised that they had the ability to modify the conditions on the existing licence, at their discretion.

Ms Syddell reiterated that residents did not have a problem with events being held at the premises, as long as they were not able to hear them. It was also reported that smokers using the rear garden of the premises tended to throw their cigarette butts over the fence into the gardens and also caused smoke to come in through neighbours' windows, which did cause a nuisance.

In summing up, Mr Pearce outlined the options open to the Committee; he stated that he did not believe that revocation was an appropriate step in this case, but that the Committee could exclude regulated entertainment from the licence, as this would enable the association to apply for TENs for any events they wished to hold. If the Committee decided to keep regulated entertainment on the licence, then Mr Pearce recommended that the existing conditions be retained, although the Committee may wish to consider the practicality of the conditions regarding mechanical ventilation and sound insulation. Ms Syddell concluded by saying that residents did not have a problem with events being held at the premises, as long as they were not able to hear them and that no smoking was permitted in the rear garden of the premises.

The applicants summed up and felt that it would be expensive and time-consuming to apply for TENs whenever they wished to hold an event, and asked that regulated entertainment be retained on the licence. They felt that by working in cooperation with local residents, they would be able to operate without causing further problems. By setting sound levels so that sound was not audible from neighbouring properties, keeping doors and windows closed and preventing smoking at the rear of the premises it was felt that the premises could be managed effectively and in a cost-effective way. The applicants apologised again for the problems caused in the past.

The Committee adjourned to deliberate.

RESOLVED

The Committee carefully considered the review application, all representations, the statutory guidance and the borough's licensing policy. The Committee decided to deal with the application by modifying its conditions as follows:

In addition to the existing conditions under 'outside areas' on the existing licence, no smoking is permitted in the rear garden at any time. This is due to evidence that smoking has caused nuisance to nearby residences, taking into account that the frontage of the premises permits adequate capacity for smoking.

The licence holder will also need to display on the front of the premises the minimum of two complaint contact telephone numbers that they already need to supply, so that these are clearly visible at all times from the outside of the premises. This is to strengthen the condition dealing with complaints.

**MINUTES OF THE LICENSING SUB COMMITTEE B
THURSDAY, 29 NOVEMBER 2012**

	<p>The Committee considered the condition relating to acoustic sound insulation to be disproportionate, based on evidence heard as to its cost, and so that condition is removed. This is on the basis that the other conditions ensuring adequate limitation of noise should be sufficient if properly exercised.</p> <p>The Committee considered the following important:</p> <ol style="list-style-type: none"> 1. that there is a new Chair of the community centre in post; 2. the previous kitchen manager is no longer in post, who was credibly associated with the causes of the previous issues; and 3. the fact that the resident who spoke at the Committee confirmed that matters had already recently improved. <p>The representatives for the licence holder came across as credible and willing to operate lawfully. The Committee did not consider it proportionate to remove an entire licensable activity, namely Regulated Entertainment, taking everything into account.</p> <p>As an informative, the licence holder is advised that, in order not to operate in breach of the licence conditions, (as amended today), they should actively cooperate with local residents, as well as environmental health and the licensing authority in ensuring that noise is not audible from the boundary of nearby residential properties. The Committee has taken a decision based on trust that there is a genuine willingness to immediately resolve the issues giving rise to the review.</p>
<p>PRCE56.</p>	<p>SHAMATA, 445 GREEN LANES, LONDON N4 1HA (HARRINGAY WARD)</p> <p>The Licensing Officer, Dale Barrett, advised that the application in respect of Shamata no longer required a hearing, as the representations against the application had been withdrawn as a result of mediation.</p>
<p>PRCE57.</p>	<p>ITEMS OF URGENT BUSINESS</p> <p>There were no new items of urgent business.</p> <p>The meeting closed at 2100hrs.</p>

CLLR ALI DEMIRCI
Chair

This page is intentionally left blank

LICENSING SUB-COMMITTEE HEARINGS PROCEDURE SUMMARY	
INTRODUCTION	
1.	The Chair introduces himself and invites other Members, Council officers, Police, Applicant and Objectors to do the same.
2.	The Chair invites Members to disclose any prior contacts (before the hearing) with the parties or representations received by them
3.	The Chair explains the procedure to be followed by reference to this summary which will be distributed.
NON-ATTENDANCE BY PARTY OR PARTIES	
4.	If one or both of the parties fails to attend, the Chair decides whether to:
	(i) grant an adjournment to another date, or
	(ii) proceed in the absence of the non-attending party.
	Normally, an absent party will be given one further chance to attend.
TOPIC HEADINGS	
5.	The Chair suggests the “topic headings” for the hearing. In the case of the majority of applications for variation of hours, or other terms and conditions, the main topic is:
	Whether the extensions of hours etc. applied for would conflict with the four licensing objectives i.e.
	(i) the prevention of crime and disorder,
	(ii) public safety,
	(iii) the prevention of public nuisance, and
	(iv) the protection of children from harm.
6.	The Chair invites comments from the parties on the suggested topic headings and decides whether to confirm or vary them.
WITNESSES	
7.	The Chair asks whether there are any requests by a party to call a witness and decides any such request.
8.	Only if a witness is to be called, the Chair then asks if there is a request by an opposing party to “cross-examine” the witness. The Chair then decides any such request.
DOCUMENTARY EVIDENCE	
9.	The Chair asks whether there are any requests by any party to introduce late documentary evidence.
10.	If so, the Chair will ask the other party if they object to the admission of the late documents.
11.	If the other party do object to the admission of documents which have only been produced by the first party at the hearing, then the documents shall not be admitted.

12.	If the other party object to documents produced late but before the hearing, the following criteria shall be taken into account when the Chair decides whether or not to admit the late documents:	
(i)	What is the reason for the documents being late?	
(ii)	Will the other party be unfairly taken by surprise by the late documents?	
(iii)	Will the party seeking to admit late documents be put at a major disadvantage if admission of the documents is refused?	
(iv)	Is the late evidence really important?	
(v)	Would it be better and fairer to adjourn to a later date?	
THE LICENSING OFFICER'S INTRODUCTION		
13.	The Licensing Officer introduces the report explaining, for example, the existing hours, the hours applied for and the comments of the other Council Services or outside official bodies. This should be as "neutral" as possible between the parties.	
14.	The Licensing Officer can be questioned by Members and then by the parties.	
THE HEARING		
15.	This takes the form of a discussion led by the Chair. The Chair can vary the order as appropriate but it should include:	
(i)	an introduction by the Objectors' main representative	
(ii)	an introduction by the Applicant or representative	
(iii)	questions put by Members to the Objectors	
(iv)	questions put by Members to the Applicant	
(v)	questions put by the Objectors to the Applicant	
(vi)	questions put by the Applicant to the Objectors	
CLOSING ADRESSES		
16.	The Chair asks each party how much time is needed for their closing address, if they need to make one.	
17.	Generally, the Objectors make their closing address before the Applicant who has the right to the final closing address.	
THE DECISION		
18.	Members retire with the Committee Clerk and legal representative to consider their decision including the imposition of conditions.	
19.	The decision is put in writing and read out in public by the Committee Clerk once Members have returned to the meeting.	

Licensing Act 2003 Sub-Committee on 22nd January 2013

Report title: Application for a New Premises Licence at BAR ESTEBAN, GOUND FLOOR, 29 PARK ROAD, LONDON N8 8TE

Report of: The Lead Officer Licensing

Ward(s) affected Crouch End

1. Purpose

To consider an application by Bar Esteban Limited allow Supply of Alcohol, Provision of Live Music, Recorded Music and Late Night Refreshment.

2. Recommendations

- 2.1 (a) Grant the application as asked
 (b) Modify the conditions of the licence, by altering or omitting or adding to them
 (c) Reject the whole or part of the application

The Committee is asked to note that it may not modify the conditions or reject the whole or part of the application unless it is appropriate to promote the licensing objectives.

Report authorised by: Joan Hancox

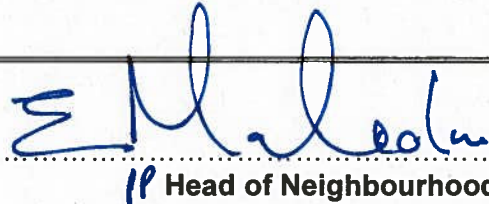

Head of Neighbourhood Services

Contact Officer: Ms Daliah Barrett -Williams

Telephone: 020 8489 8232

3. Executive summary

For consideration by Licensing Sub Committee under Licensing Act 2003 for a Premises licence with variation to the existing conditions

4. Access to information:

Local Government (Access to Information) Act 1985

Background Papers

The following Background Papers are used in the preparation of this Report:

File: Bar Esteban

The Background Papers are located at Enforcement Service, Technopark, Ashley Road, Tottenham N17

This page is intentionally left blank

5. REPORT

Background

5.1 An application for a new Premises Licence, by Bar Esteban Limited in respect of Bar Esteban under the Licensing Act 2003.

5.2 **Details of the application being sought under the Premises Licence—APP 1**

The Provision of Regulated Entertainment: Live Music and Recorded Music

Monday to Thursday:	1000 to 0000
Friday to Saturday:	1000 to 0030
Sunday:	1000 to 2330

Late Night Refreshment

Monday to Thursday:	1000 to 0000
Friday to Sunday:	1000 to 0030

Supply of Alcohol

Monday to Thursday:	1000 to 0000
Friday to Saturday:	1000 to 0030
Sunday:	1000 to 2330

For consumption **ON** the premises

Hours open to the public

Monday to Thursday	0800 to 0000
Friday to Sunday:	0800 to 0030

New Years Eve the timing requested is from the start of permitted hours on 31st December until the start of the permitted hours on 1 January, Christmas Day and Good Friday 1200 to 0000.

General-all four licensing objectives

All endeavours will be made to meet all four Licensing objectives and to comply with the directions and recommendations of all the relevant bodies.

5.3 Crime and Disorder

This is a restaurant premises which has been licensed for almost 20 years without any incident, breach or disorder and will continue to operate as a family orientated restaurant providing good value and high end cuisine.

5.4 Public Safety

All Fire and Safety regulations will be complied with and all recommendations or directions given by all the appropriate local authority fire and environmental departments will be observed and implemented. As well as any other directions, guidelines or recommendations from any other relevant body upon whom notice of this application has been served.

5.5 Public Nuisance

This will be a high end restaurant catering for families and discerning diners and has operated as such for many years without complaint as to nuisance or crime. All efforts will be made to ensure that the restaurant is run in a professional manner without offence nuisance or interruption to any neighbour or general public. All recommendations and guidelines and regulations from all the relevant bodies will be complied with and implemented.

5.6 Child Protection

All the required safety regulations by way of fire and otherwise will be implemented and the premises will be equipped to seat children of all ages safely. All environmental regulations and recommendations by all relevant bodies will be complied with to ensure the safety of children dining. The interest of children will be paramount.

If in doubt of a child's age as far as it relates to the consumption of alcohol on the premises identification will be requested by way of driving licence or other appropriate identification and all staff will be trained to carry this out.

6. RELEVANT REPRESENTATIONS (CONSULTATION)

Responsible authorities:

6.1 Comments of Metropolitan Police

Made representation regarding this application, but have now withdrawn their representation as they are satisfied with the control measures proposed to be implemented in relation to the Prevention of Crime and Disorder **Appendix 2**

6.2 Comments of Regulatory Services:

Environmental Health

Made representation regarding this application, but have now withdrawn their representation as they are satisfied with the control measures proposed to be implemented in relation to the Prevention of Public Nuisance. **Appendix 3**

Trading Standards

Made representation regarding this application, but have now withdrawn their representation as they are satisfied with the control measures proposed to be implemented in relation to the Protection of Children from Harm **Appendix 4**

6.3 London Fire and Civil Defence Authority

Have made no representation to this application

6.4 Planning Services

Have made no representation to this application

6.5 Comments of Child Protection Agency or Nominee

No representation made on this matter

7.0 Interested Parties – Appendix 5

Representation has been received against this application. The applicants and their representative have written to the resident to answer the concerns that have been raised, copies of their letters are attached at Appendix 5A.

8.0 Financial Comments

The fee which would be applicable for this application was **£190.00**.

APPENDIX 1 – APPLICATION

HG1043 131
 WK/237580
 LN/000010595



Application for a premises licence to be granted under the Licensing Act 2003

Haringey Council

PLEASE READ THE FOLLOWING INSTRUCTIONS FIRST

Before completing this form please read the guidance notes at the end of the form. If you are completing this form by hand please write legibly in block capitals. In all cases ensure that your answers are inside the boxes and written in black ink. Use additional sheets if necessary.

You may wish to keep a copy of the completed form for your records.

I Stephen Lironi Director of Esteban Ltd (The Applicant)

(Insert name(s) of applicant)

apply for a premises licence under section 17 of the Licensing Act 2003 for the premises described in Part 1 below (the premises) and I/we are making this application to you as the relevant licensing authority in accordance with section 12 of the Licensing Act 2003

Part 1 – Premises Details

Postal address of premises or, if none, ordnance survey map reference or description			
Bar Esteban Ground Floor 29 Park Road			
Post town	London	Post code	N8 8TE
Telephone number at premises (if any)			
Non-domestic rateable value of premises		£28,250	

Part 2 - Applicant Details

Please state whether you are applying for a premises licence as
 Please tick yes

- a) an individual or individuals * please complete section (A)
- b) a person other than an individual *
 - i. as a limited company please complete section (B)
 - ii. as a partnership please complete section (B)
 - iii. as an unincorporated association or please complete section (B)

- iv. other (for example a statutory corporation) please complete section (B)
- c) a recognised club please complete section (B)
- d) a charity please complete section (B)
- e) the proprietor of an educational establishment please complete section (B)
- f) a health service body please complete section (B)
- g) a person who is registered under Part 2 of the Care Standards Act 2000 (c14) in respect of an independent hospital in Wales please complete section (B)
- ga) a person who is registered under Chapter 2 of Part 1 of the Health and Social Care Act 2008 (within the meaning of that Part) in an independent hospital in England please complete section (B)
- h) the chief officer of police of a police force in England and Wales please complete section (B)

* If you are applying as a person described in (a) or (b) please confirm:

Please tick yes

- I am carrying on or proposing to carry on a business which involves the use of the premises for licensable activities; or
- I am making the application pursuant to a
 - statutory function or
 - a function discharged by virtue of Her Majesty's prerogative

(A) INDIVIDUAL APPLICANTS (fill in as applicable)

<input type="checkbox"/> Mr	<input type="checkbox"/> Mrs	<input type="checkbox"/> Miss	<input type="checkbox"/> Ms	Other Title (for example, Rev)	
Surname			First names		
I am 18 years old or over				<input type="checkbox"/> Please tick yes	
Current postal address if different from premises address					
Post Town				Postcode	
Daytime contact telephone number					
E-mail address (optional)					

SECOND INDIVIDUAL APPLICANT (if applicable)

Mr <input type="checkbox"/>	Mrs <input type="checkbox"/>	Miss <input type="checkbox"/>	Ms <input type="checkbox"/>	Other Title (for example, Rev)	
Surname			First names		
I am 18 years old or over					<input type="checkbox"/> Please tick yes
Current postal address if different from premises address					
Post Town				Postcode	
Daytime contact telephone number					
E-mail address (optional)					

(B) OTHER APPLICANTS

Please provide name and registered address of applicant in full. Where appropriate please give any registered number. In the case of a partnership or other joint venture (other than a body corporate), please give the name and address of each party concerned.

Name Bar Esteban Limited
Address 7 St Johns Road Harrow Middlesex HA1
Registered number (where applicable) 8206610
Description of applicant (for example, partnership, company, unincorporated association etc.) Company
Telephone number (if any) 07767761160 (Stephen Lironi Director)
E-mail address (optional)

Part 3 Operating Schedule

When do you want the premises licence to start?

Day		Month		Year			
0	3	0	1	2	0	1	3

If you wish the licence to be valid only for a limited period, when do you want it to end?

Day		Month		Year			

Please give a general description of the premises (please read guidance note1)

The premises is a restaurant and has traded as such for almost 20 years without any problems. The reason for the application is that the previous tenant company had gone into liquidation in July of 2011 and the current intended purchaser or freeholder was not aware of this and the License had inadvertently lapsed.

What consideration have you given to the immediate locality with regards to the licensable activities you are applying for?

This is an existing licensed premises as described above. The intended nature of the venture will be that of an up market Spanish restaurant providing high quality Spanish Tapas as well as a very carefully chosen wine list representing different regions of Spain.

If 5,000 or more people are expected to attend the premises at any one time, please state the number expected to attend.

What licensable activities do you intend to carry on from the premises?

(Please see sections 1 and 14 of the Licensing Act 2003 and Schedules 1 and 2 to the Licensing Act 2003)

Provision of regulated entertainment

Please tick yes

- a) plays (if ticking yes, fill in box A)
- b) films (if ticking yes, fill in box B)
- c) indoor sporting events (if ticking yes, fill in box C)
- d) boxing or wrestling entertainment (if ticking yes, fill in box D)
- e) live music (if ticking yes, fill in box E)
- f) recorded music (if ticking yes, fill in box F)
- g) performances of dance (if ticking yes, fill in box G)
- h) anything of a similar description to that falling within (e), (f) or (g) (if ticking yes, fill in box H)

Provision of entertainment facilities:

- i) making music (if ticking yes, fill in box I)
- j) dancing (if ticking yes, fill in box J)
- k) entertainment of a similar description to that falling within (i) or (j) (if ticking yes, fill in box K)

Provision of late night refreshment (if ticking yes, fill in box L)

Supply of alcohol (if ticking yes, fill in box M)

In all cases complete boxes N, O and P

A

Plays Standard days and timings (please read guidance note 6)			<u>Will the performance of a play take place indoors or outdoors or both – please tick</u> (please read guidance note 2)	Indoors	<input type="checkbox"/>
Day	Start	Finish		Outdoors	<input type="checkbox"/>
				Both	<input type="checkbox"/>
Mon				<u>Please give further details here</u> (please read guidance note 3)	
Tue					
Wed			<u>State any seasonal variations for performing plays</u> (please read guidance note 4)		
Thur					
Fri			<u>Non standard timings. Where you intend to use the premises for the performance of plays at different times to those listed in the column on the left, please list</u> (please read guidance note 5)		
Sat					
Sun					

B

Films Standard days and timings (please read guidance note 6)			<u>Will the exhibition of films take place indoors or outdoors or both – please tick</u> (please read guidance note 2)	Indoors	<input type="checkbox"/>
				Outdoors	<input type="checkbox"/>
Day	Start	Finish		Both	<input type="checkbox"/>
Mon			<u>Please give further details here</u> (please read guidance note 3)		
Tue					
Wed			<u>State any seasonal variations for the exhibition of films</u> (please read guidance note 4)		
Thur					
Fri			<u>Non standard timings. Where you intend to use the premises for the exhibition of films at different times to those listed in the column on the left, please list</u> (please read guidance note 5)		
Sat					
Sun					

C

Indoor sporting events Standard days and timings (please read guidance note 6)			<u>Please give further details</u> (please read guidance note 3)
Day	Start	Finish	
Mon			<u>State any seasonal variations for indoor sporting events</u> (please read guidance note 4)
Tue			
Wed			
Thur			<u>Non standard timings. Where you intend to use the premises for indoor sporting events at different times to those listed in the column on the left, please list</u> (please read guidance note 5)
Fri			
Sat			
Sun			

D

Boxing or wrestling entertainments Standard days and timings (please read guidance note 6)			<u>Will the boxing or wrestling entertainment take place indoors or outdoors or both – please tick</u> (please read guidance note 2)	Indoors	<input type="checkbox"/>
				Outdoors	<input type="checkbox"/>
				Both	<input type="checkbox"/>
Day	Start	Finish	<u>Please give further details here</u> (please read guidance note 3)		
Mon	1				
Tue			<u>State any seasonal variations for boxing or wrestling entertainment</u> (please read guidance note 4)		
Wed					
Thur			<u>Non standard timings. Where you intend to use the premises for boxing or wrestling entertainment at different times to those listed in the column on the left, please list</u> (please read guidance note 5)		
Fri					
Sat					
Sun					

E

Live music Standard days and timings (please read guidance note 6)			<u>Will the performance of live music take place indoors or outdoors or both – please tick</u> (please read guidance note 2)	Indoors	<input checked="" type="checkbox"/>
				Outdoors	<input type="checkbox"/>
				Both	<input type="checkbox"/>
Day	Start	Finish			
Mon	10.00	0000	<u>Please give further details here</u> (please read guidance note 3) The music will be more background music and will be at a level so that diners are not disturbed and can converse comfortably		
Tue	10.00	0000			
Wed	10.00	0000	<u>State any seasonal variations for the performance of live music</u> (please read guidance note 4)		
Thur	10.00	0000	New Years Eve the timing requested is from the start of permitted hours on 31 December until the start of permitted hours on 1 January Christmas Day and Good Friday 1200 to 0000		
Fri	10.00	0030	<u>Non standard timings. Where you intend to use the premises for the performance of live music at different times to those listed in the column on the left, please list</u> (please read guidance note 5)		
Sat	10.00	0030			
Sun	10.00	2330			

F

Recorded music Standard days and timings (please read guidance note 6)			<u>Will the playing of recorded music take place indoors or outdoors or both – please tick</u> (please read guidance note 2)	Indoors	<input checked="" type="checkbox"/>
				Outdoors	<input type="checkbox"/>
				Both	<input type="checkbox"/>
Day	Start	Finish			
Mon	10.00	0000	<u>Please give further details here</u> (please read guidance note 3) The music will be background music so that restaurant diners are not disturbed and can converse normally without interruption. The music will remain at a level that is not above normal conversation.		
Tue	10.00	0000			
Wed	10.00	0000	<u>State any seasonal variations for the playing of recorded music</u> (please read guidance note 4)		
Thur	10.00	0000			
Fri	10.00	0030	<u>Non standard timings. Where you intend to use the premises for the playing of recorded music at different times to those listed in the column on the left, please list</u> (please read guidance note 5) New Years Eve from the start of permitted hours on 31 December until start of permitted hours on 1 January. Christmas Day and Good Friday 1200 to 0000.		
Sat	10.00	0030			
Sun	10.00	2330			

G

Performances of dance Standard days and timings (please read guidance note 6)			<u>Will the performance of dance take place indoors or outdoors or both – please tick</u> (please read guidance note 2)	Indoors	<input type="checkbox"/>
				Outdoors	<input type="checkbox"/>
				Both	<input type="checkbox"/>
Day	Start	Finish	<u>Please give further details here</u> (please read guidance note 3)		
Mon					
Tue			<u>State any seasonal variations for the performance of dance</u> (please read guidance note 4)		
Wed					
Thur			<u>Non standard timings. Where you intend to use the premises for the performance of dance at different times to those listed in the column on the left, please list</u> (please read guidance note 5)		
Fri					
Sat					
Sun					

H

<p>Anything of a similar description to that falling within (e), (f) or (g) Standard days and timings (please read guidance note 6)</p>			<p><u>Please give a description of the type of entertainment you will be providing</u></p>		
Day	Start	Finish	<p><u>Will this entertainment take place indoors or outdoors or both – please tick</u> (please read guidance note 2)</p>	Indoors	<input type="checkbox"/>
Mon				Outdoors	<input type="checkbox"/>
				Both	<input type="checkbox"/>
Tue			<p><u>Please give further details here</u> (please read guidance note 3)</p>		
Wed					
Thur			<p><u>State any seasonal variations for entertainment of a similar description to that falling within (e), (f) or (g)</u> (please read guidance note 4)</p>		
Fri					
Sat			<p><u>Non standard timings. Where you intend to use the premises for the entertainment of a similar description to that falling within (e), (f) or (g) at different times to those listed in the column on the left, please list</u> (please read guidance note 5)</p>		
Sun					

I

Provision of facilities for making music Standard days and timings (please read guidance note 6)			<u>Please give a description of the facilities for making music you will be providing</u>	
			<u>Will the facilities for making music be indoors or outdoors or both – please tick</u> (please read guidance note 2)	
Day	Start	Finish	Indoors	<input type="checkbox"/>
			Outdoors	<input type="checkbox"/>
			Both	<input type="checkbox"/>
Mon			<u>Please give further details here</u> (please read guidance note 3)	
Tue			<u>Please give further details here</u> (please read guidance note 3)	
Wed			<u>State any seasonal variations for the provision of facilities for making music</u> (please read guidance note 4)	
Thur			<u>State any seasonal variations for the provision of facilities for making music</u> (please read guidance note 4)	
Fri			<u>Non standard timings. Where you intend to use the premises for provision of facilities for making music at different times to those listed in the column on the left, please list</u> (please read guidance note 5)	
Sat				
Sun				

J

Provision of facilities for dancing Standard days and timings (please read guidance note 6)			Will the facilities for dancing be indoors or outdoors or both – please tick (see guidance note 2)	Indoors	<input type="checkbox"/>
				Outdoors	<input type="checkbox"/>
				Both	<input type="checkbox"/>
			<u>Please give a description of the facilities for dancing you will be providing</u>		
Day	Start	Finish	<u>Please give further details here</u> (please read guidance note 3)		
Mon					
Tue					
Wed					
Thur					
Fri					
Sat					
Sun					
			<u>State any seasonal variations for providing dancing facilities</u> (please read guidance note 4)		
			<u>Non standard timings. Where you intend to use the premises for the provision of facilities for dancing entertainment at different times to those listed in the column on the left, please list</u> (please read guidance note 5)		

K

Provision of facilities for entertainment of a similar description to that falling within i or j Standard days and timings (please read guidance note 6)			<u>Please give a description of the type of entertainment facility you will be providing</u>		
Day	Start	Finish	<u>Will the entertainment facility be indoors or outdoors or both – please tick</u> (please read guidance note 2)	Indoors	<input type="checkbox"/>
Mon				Outdoors	<input type="checkbox"/>
				Both	<input type="checkbox"/>
Tue			<u>Please give further details here</u> (please read guidance note 3)		
Wed					
Thur			<u>State any seasonal variations for the provision of facilities for entertainment of a similar description to that falling within i or j</u> (please read guidance note 4)		
Fri					
Sat			<u>Non standard timings. Where you intend to use the premises for the provision of facilities for entertainment of a similar description to that falling within i or j at different times to those listed in the column on the left, please list</u> (please read guidance note 5)		
Sun					

L

Late night refreshment Standard days and timings (please read guidance note 6)			Will the provision of late night refreshment take place indoors or outdoors or both – please tick (please read guidance note 2)	Indoors	<input checked="" type="checkbox"/>
				Outdoors	<input type="checkbox"/>
				Both	<input type="checkbox"/>
Day	Start	Finish			
Mon	10.00	0000	<u>Please give further details here</u> (please read guidance note 3) The premises will operate as a high end restaurant		
Tue	10.00	0000			
Wed	10.00	0000	<u>State any seasonal variations for the provision of late night refreshment</u> (please read guidance note 4)		
Thur	10.00	0000			
Fri	10.00	0030	<u>Non standard timings. Where you intend to use the premises for the provision of late night refreshment at different times, to those listed in the column on the left, please list</u> (please read guidance note 5) New Years Eve from the start of permitted hours on 31 December until start of permitted hours on 1 January. Christmas Day and Good Friday 1200 to 0000		
Sat	10.00	0030			
Sun	10.00	0030			

M

Supply of alcohol Standard days and timings (please read guidance note 6)			Will the supply of alcohol be for consumption (Please tick box) (please read guidance note 7)	On the premises	<input checked="" type="checkbox"/>
				Off the premises	<input type="checkbox"/>
				Both	<input type="checkbox"/>
Day	Start	Finish	State any seasonal variations for the supply of alcohol (please read guidance note 4)		
Mon	10.00	0000			
Tue	10.00	0000			
Wed	10.00	0000			
Thur	10.00	0000			
Fri	10.00	0030			
Sat	10.00	0030			
Sun	10.00	2330			
			Non standard timings. Where you intend to use the premises for the supply of alcohol at different times to those listed in the column on the left, please list (please read guidance note 5)		
			New Years Eve from the start of permitted hours on 31 December until start of permitted hours on 1 January. Christmas Day and Good Friday 1200 to 0000		

State the name and details of the individual whom you wish to specify on the licence as premises supervisor

Name Stephen Lironi	
Address 1 Hatherley Gardens London N8 9JH	
Postcode	
Personal Licence number (if known) LN000010407	
Issuing licensing authority (if known) London Borough of Haringey	

N

Please highlight any adult entertainment or services, activities, other entertainment or matters ancillary to the use of the premises that may give rise to concern in respect of children (please read guidance note 8)

There will be none

O

Hours premises are open to the public Standard days and timings (please read guidance note 6)			State any seasonal variations (please read guidance note 4)
Day	Start	Finish	
Mon	08.00	0000	
Tue	08.00	0000	
Wed	08.00	0000	
Thur	08.00	0000	
Fri	08.00	0030	Non standard timings. Where you intend the premises to be open to the public at different times from those listed in the column on the left, please list (please read guidance note 5) New Years Eve from the start of permitted hours on 31 December until start of permitted hours on 1 January. Christmas Day and Good Friday 1200 to 0000
Sat	08.00	0030	
Sun	08.00	0030	

P Describe the steps you intend to take to promote the four licensing objectives:

a) General – all four licensing objectives (b,c,d,e) (please read guidance note 9)

All endeavors will we made to meet all 4 Licensing objectives and to comply with the directions and recommendations of all the relevant bodies.

b) The prevention of crime and disorder

This is a restaurant premises which has been licensed for almost 20 years without any incident or breach or disorder and will continue to operated as a family orientated restaurant providing good value and high end cuisine

c) Public safety

All Fire and Safety Regulations will be complied with and all recommendations or directions given by all the appropriate local authority fire and environmental departments will be observed and implemented as well as any other directions, guidelines or recommendations from any other relevant body upon whom notice of this application has been served.

d) The prevention of public nuisance

This will be a high end restaurant catering for families and discerning diners and has operated as such for many years without complain as to nuisance or crime. All efforts will be made to ensure that the restaurant is run in a professional manner without offence nuisance or interruption to any neighbour or general public and all recommendations and guidelines and regulations from all the relevant bodies will be complied with and implemented.

e) The protection of children from harm

All the required safety regulations by way of fire and otherwise will be implemented and the premises will be equipped to seat children of all ages safely and all environmental regulations and recommendations by all relevant bodies will be complied with to ensure the safety of the children diners. The interest of the children will be paramount. If in doubt of a child's age as far as it relates to the consumption of alcohol on the premises identification will be requested by way of driving licence or other appropriate identification and all staff will be trained to carry this out.

Please tick yes

- I have made or enclosed payment of the fee
- I have enclosed the plan of the premises
- I have sent copies of this application and the plan to responsible authorities and others where applicable
- I have enclosed the consent form completed by the individual I wish to be premises supervisor, if applicable
- I understand that I must now advertise my application
- I understand that if I do not comply with the above requirements my application will be rejected

IT IS AN OFFENCE, LIABLE ON CONVICTION TO A FINE UP TO LEVEL 5 ON THE STANDARD SCALE, UNDER SECTION 158 OF THE LICENSING ACT 2003 TO MAKE A FALSE STATEMENT IN OR IN CONNECTION WITH THIS APPLICATION

Part 4 – Signatures (please read guidance note 10)

Signature of applicant or applicant’s solicitor or other duly authorised agent (See guidance note 11). **If signing on behalf of the applicant please state in what capacity.**

Signature	
Date	27 November 2012
Capacity	Solicitor

For joint applications signature of 2nd applicant or 2nd applicant’s solicitor or other authorised agent. (please read guidance note 12). **If signing on behalf of the applicant please state in what capacity.**

Signature	
Date	
Capacity	

Contact name (where not previously given) and postal address for correspondence associated with this application (please read guidance note 13)			
Nick Demos P George & Co Solicitors 42 Elder Avenue			
Post town	London	Post code	N8 8PS
Telephone number (if any)	020 8341 9080		
If you would prefer us to correspond with you by e-mail your e-mail address (optional) info@pgeorgesolicitors.co.uk			



Haringey Council

Consent of individual to being specified as premises supervisor

Reference number:

I [full name of prospective premises supervisor]
STEPHEN LIRONI

of [home address of prospective premises supervisor]
1 HATHERLEY GARDENS
LONDON
N8

hereby confirm that I give my consent to be specified as the designated premises supervisor in relation to the application for

[type of application]
NEW PREMISES LICENCE

by [name of applicant]
ESTEBAN LIMITED

relating to a premises licence

[number of existing licence, if any] N/A

for [name and address of premises to which the application relates]
BAR ESTEBAN
GROUND FLOOR
29 PARK ROAD
LONDON N8 8TE

and any premises licence to be granted or varied in respect of this application made by

[name of applicant]
N/A

[name and address of premises to which application relates]

BAR ESTEBAN
 29 PARK ROAD
 LONDON
 N8 8TE

I also confirm that I am applying for, intend to apply for or currently hold a personal licence, details of which I set out below.

Personal licence number LN 000070407
 [insert personal licence number, if any]

Personal licence issuing authority
 [insert name and address and telephone number of personal licence issuing authority, if any]

L.B HARINGEY
 THE LICENSING TEAM
 UNIT 271 LEE VALLEY TECHOPARK
 ASHLEY ROAD
 TOTTENHAM HALE
 LONDON N17 9LN

Signed 

Name (please print) STEPHEN LIRONI

Date 28/11/12

- KEY**
- FE = FIRE ESCAPE
 - S = SMOKE ALARM
 - FD = FIRE DOOR
 - FB = FIRE BLANKET
 - F = FIRE EXTINGUISHER

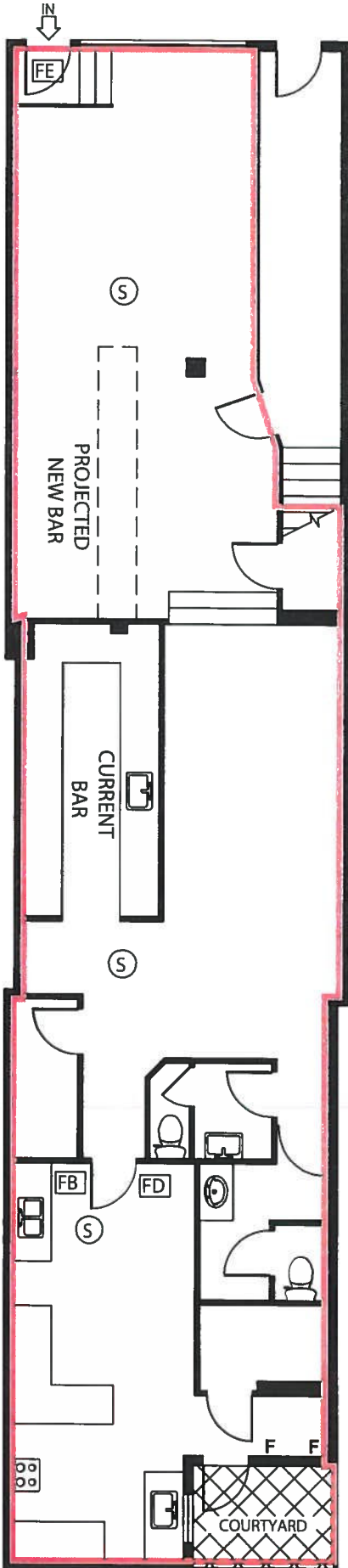

LEASE PLANNERS
 WWW.LEASEPLANNERS.CO.UK

DRAWING TITLE -
 29 PARK ROAD
 CROUCH END
 LONDON
 N8

DATE -
 19 NOVEMBER 2012

REVISION
 1 OF 1



SCALE: 1:100 AT A4

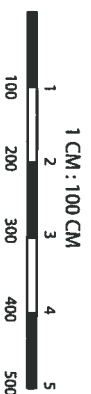

SCALE: For the plan to be scale, the above scale bar must measure correct when printed (for example 5cm)

APPENDIX 2 – METROPOLITAN POLICE REPRESENTATION



**METROPOLITAN
POLICE**

Working together for a safer London

POLICE REPRESENTATION

Name and address of premises:

Bar Esteban, 29 Park Road N8 8TE

Type of Application: New Premises Licence.

I wish to make representation on the following:

- Prevention of crime and disorder

If this application were granted in full or part, I would recommend the following alterations be made to the licence conditions. I also suggest that additional conditions be attached to the licence, as set out below, to further promote the licensing objectives.

	Current Conditions	Recommendation
1	CCTV System will be installed.	<p>A digital CCTV system to be installed in the premises.</p> <p>Cameras must be sited to observe the entrance doors from the inside.</p> <p>Cameras on the entrances must capture full frame shots of the heads and shoulders of all people entering the premises i.e. capable of identification.</p> <p>Provide a linked record of the date, time, and place of any image.</p> <p>Provide good quality images - colour during opening times.</p>

2		<p>Have a monitor to review images and recorded quality.</p> <p>Be regularly maintained to ensure continuous quality of image capture and retention.</p> <p>Staff trained in operating CCTV.</p> <p>Digital images must be kept for 31 days. The equipment must have a suitable export method, e.g. CD/DVD writer so that Police can make an evidential copy of the data they require. Copies must be available within a reasonable time to Police on request.</p> <p>Venue should close to the public 30 minutes after alcohol sales cease to allow a wind down time.</p>
---	--	--

This is under the Protection of Children from Harm Objective.

Challenge 25 Policy Implemented:

I recommend that the following form of verification of a person's proof of age is:

- A valid passport.
- A photo driving licence
- A proof of age standard card system
- A citizen card, supported by the Home Office.

If these conditions were accepted in full I would withdraw my representation.

Officer: Mark Greaves
Licensing Officer Haringey Police

Tel: 020 3276 0150

Mark.Greaves@Met.Police.UK

Date: 11th December 2012

**APPENDIX 3 – ENVIROMENTAL HEALTH- ENFORCEMENT RESPONSE
REPRESENTATION**

Shah Noshaba

From: Nicolaou George (Enforcement)
Sent: 30 November 2012 15:43
To: Shah Noshaba, Licensing
Cc: Pearce Derek
Subject: WK/000237580
M3PPRef: WK/000237580
M3PPUnique: 00000004319E77AA8F6D211B04E00805FA682C2070091B275CEE796D011AFE900805FA682C200000096322C0000810D9B31C4A36243A85A2CF2809983E9000

Licensing Consultation

To: Licensing Officer

From: Enforcement Response Officer (Noise)

Name of Officer preparing representation: GEORGE NICOLAOU
 cc: Team Leader Enforcement Response, Derek Pearce

Our Reference: WK/000237580

Date: 30th November 2012

Premises: Bar Esteban, Shop, 29 Park Road, Hornsey, London, N8 8TE

Type of application: New

I would like to confirm that I have considered the above proposal with regard to the prevention of public nuisance on behalf of the Enforcement Response (Noise) Team & would like to make representations to the Application

The operating schedule does not address the prevention of public nuisance from:

- airborne entertainment noise
- Structure borne noise or vibrations from entertainment
- Noise generated by patrons in external areas of the premises
- Noise generated from deliveries
- Noise generated from refuse collections
- Noise from plant and machinery
- Light nuisance
- Cooking odour

Prevention of nuisance from noise / vibration

All doors and windows will remain closed during the licensed regulated entertainment activities or in any event after 11pm. The entrance door will be fitted with a self-closing device and staff required to ensure that it is not propped open. A member of staff shall be made responsible to ensure the door is opened for as brief a period as possible. Where necessary adequate and suitable mechanical ventilation should be provided to public areas

The regulated entertainment licensable activity shall conclude 30 minutes before the premises is due to close to prevent excessive noise breakout as the premises empties

Structure borne noise

All speakers are mounted on anti-vibration mountings to prevent vibration transmission of sound energy to adjoining properties

Sound limits

The licensee shall ensure that no music played in the licensed premises is audible at or within the site boundary of any residential property

All regulated entertainment amplified activity will utilise the in-house amplification system, the maximum output of which is controlled by the duty manager

The level of amplified regulated entertainment shall be controlled by means of limiting device set at a level which upon request may be agreed with the licensing authority

Outside Areas

No music will be played in, or for the benefit of patrons in external areas of the premises premises

No form of loudspeaker or sound amplification equipment is to be sited on or near the exterior premises or in or near any foyer, doorway, window or opening to the premises

Signs shall be displayed in the external areas/on the frontage requesting patrons to recognise the residential nature of the area and conduct their behaviour accordingly. The management must reserve the right to ask patrons to move inside the premises or leave if it is felt that they could be disturbing neighbours

**APPENDIX 4 – ENVIROMENTAL HEALTH- TRADING STANDARDS
REPRESENTATION**

Anderson Chanel

From: Tillett Karen
Sent: 03 December 2012 12:22
To: Licensing
Subject: FW: Application for a Premises Licence - BAR ESTEBAN, GROUND FLOOR, 29 PARK ROAD, CROUCH END, LONDON N8 8TE (WK/237580)
Attachments: MEMO- Bar Esteban, 29 Park Road, N8.doc; Application.pdf; Premises Plan.pdf

Trading Standards wish to make the following representation:

The prevention of such activity is not completely addressed in the Licensing Objective concerning the protection of children (Section P(e)).

Measures that we would expect to see in place are:

- A fuller definition of appropriate identification i.e. that such ID must bear a photograph, date of birth and a holographic mark.
- To keep a written record of staff training confirming they have understood the legal requirements

Also recommended is the implementation of a Challenge 25 Policy although this does not form part of the representation.

Kind regards,
Karen

Karen Tillett
Joint Trading Standards Manager - Haringey and Waltham Forest
London Borough of Haringey Trading Standards
Lee Valley Technopark,
Ashley Road, Tottenham
London N17 9LN
Telephone: 020 8489 5885
Alt Telephone: 020 8489 8233
Fax: 020 8489 5554

From: Shah Noshaba
Sent: 30 November 2012 14:49
To: Building Control; Enforcement Response; Food Haringey; Pearce Derek; Planning Enforcement; Whitehouse Rebecca; Tillett Karen; Thomas Simon; 'YR_Licensing@met.pnn.police.uk'; 'Fire'; Morris Marion; Ekemezuma Felicia
Cc: Barrett Daliah; Smith Paul; Anderson Chanel
Subject: RE: Application for a Premises Licence - BAR ESTEBAN, GROUND FLOOR, 29 PARK ROAD, CROUCH END, LONDON N8 8TE (WK/237580)

Dear RA's

Please find attached a new premises licence application for the above premise.

Please note the last day of consultation is on 27th December 2012.

Could all responses please be forwarded to licensing@haringey.gov.uk

04/12/2012

APPENDIX 5 – LETTER OF REPRESENTATION FROM ‘OTHER PARTIES’

**Haringey Council
Licensing Department Team Enforcement
Service Technopark Ashley Road
Tottenham
N17 9LN**

RE: Bar Estenan 29 Park Road, Ground Floor N8 8TE -Licensing protest

Dear Sirs

With regards to the above property and its application to obtain a license for a bar till 12 to 12..30am I would strongly like to object. My grounds for this is listed below:-

- 1. It is a a public nucience to all who live above and near it due to high noise levels which are never turned down and even if they are can still be heard..**
- 2. I live above it and have experience terrible noise pollution from previous bars (i.e. Rhythm bar and bar Twenty Nine) till well past 10pm and on into the small hours of the morning and am unable to sleep.**
- 3. This is totally unacceptable as it is not sound proofed and all and everything can be heard as the walls are paper thin and there are even cracks through the floor boards into the restaurant below from above.**
- 4. All people on either side of the property and above will have no peace and this is completely unfair as everyone desires peace and quite in their own home and no noise pollution from others..**
- 5. This type of bar will only attract the worse type of people who will only bring the neighbourhood down. Again a public annoyance to all who live near it.**

Yours sincerely



**Ms Bees
27 Park Road upper floor
London
N8 8TE**



**APPENDIX 5A – COPIES OF LETTERS SENT IN RESPONSE TO REPRESENTATION
BY THE RESIDENT**



Bar Esteban

29 Park Road, London N8 8TE

January 8, 2013

Ms Bees
27 Park Road
London, N8 8TE

Dear Ms Bees

Thank you for your recent letter, which was forwarded by Haringey Council to both myself and my business partner, Stephen Lironi, earlier today.

We were sorry to hear of your distress caused by the owners of the previous bars, Rhythm and Bar 29 and wanted to write to you personally about our plans for the space.

Although the name of our restaurant does suggest a bar, we will actually be opening a Spanish tapas restaurant. We do not expect to attract a late night bar crowd, nor will we market the new business as such. We have spent the last two years researching high quality Spanish products and ingredients and special regional tapas dishes which we hope the Crouch End community will enjoy. In addition, our wine list will be specializing in Spanish wines and sherries.

In terms of noise, we are sympathetic to all of our neighbors and understand that this has been an issue in the past. We do not intend for our restaurant to have blaring music - in fact we believe that music should never drown out normal levels of conversation. In addition, we can guarantee that no speakers will be placed on the adjacent wall to your property and we do not intend to install a large music system and large speakers.

As long term residents of Crouch End, the last thing we want to do is to "attract the worse type of people" as you mention in point 5 of your letter. We hope that the restaurant will be frequented by locals who are attracted by the menu and in time hope to be as highly thought of in the neighborhood as Banners.

In light of this new information, we would greatly appreciate it, if you would consider withdrawing your letter to the council.

Finally, although not addressed in your letter of December 24th, we would like to thank you for your patience regarding any noise that may have been caused by our builders this week. This is, of course, a temporary issue and the bulk of this work should be completed in the next several days.

Should you wish to talk about any of your concerns personally, both Stephen and myself would be very happy to do so. My email is lisa@baresteban.com, please do not hesitate to contact me directly.

Your sincerely,

Lisa Woolley

Co-Owner/Director

Bar Esteban Ltd

ND/EK/L0151/1

Daliah Barrett
Haringey Council
The Licensing Team
Unit 271 Lee Valley Technopark
Ashley Road
London
N17 9LN

08 January 2013

Dear Ms Barrett

**Re: Application for New Licence
Bar Esteban
Ground Floor 29 Park Road London N8 8TE**

Thank you for your email of 8th January 2013 and for forwarding to me the letter of representation from Ms Bees.

As you are aware the premises is to run as a family restaurant and not as a music venue. You will also be aware that the live music option was on the previous premises licence which as you are aware expired due to liquidation of the previous tenant company. Our client is very happy to meet with Ms Bees to reassure her that the premises will be run in an orderly fashion as a family restaurant and the only music will be very low volume background music as in any other restaurant. In addition to this our client is quite happy to remove the application for live music on the licence as a special concession to Ms Bees in this matter.

Accordingly we should be grateful if you would convey this to Ms Bees and reassure her that the intention is to run the premises as a high end family restaurant with respectable clientele.

I look forward to hearing from you.
Yours sincerely

Nick Demos
P. George & Co

This page is intentionally left blank